

Stone

NEW PRODUCT INFORMATION

STEERING WHEEL HOLDER Pn. SA-015



Steering wheel holder is the product we have prepared for 3 years. When designing, we wanted to ensure compatibility with all known standards, and allow the setting depth and angle. ST-015 is a modular product that is using the modules to customize all types of Karts (MINI; KF, KZ ats.). SA-015 allows you to set the steering wheel from 0-20 degrees and level from X + (2x20mm). Angle adjustment is secured by screw M5. Manufacture in natural aluminum color and black.

Price 80 € (Not included TAX and transport cost)

Stone

Lojzeta Hrovata 5
SI-4000 Kranj
Slovenija
Mr.Nenad Stojsic

Phone: +38631537758

Fax:

E-mail: stone@t-2.net

Stone

NEW PRODUCT INFORMATION

**INTERFACE FOR CRG STEERING WHEEL
Pn. SA-016**



SA-016 allows you to use the steering wheel on the CRG , MARANELO , TOP-KART and other Karts with standard 45/3.

Price 15 € (Not included TAX and transport cost)

Stone

Lojzeta Hrovata 5
SI-4000 Kranj
Slovenija
Mr.Nenad Stojsic

Phone: +38631537758
Fax:
E-mail: stone@t-2.net

Stone

NEW PRODUCT INFORMATION

**INTERFACE FOR TONY-KART STEERING
WHEEL Pn. SA-017**

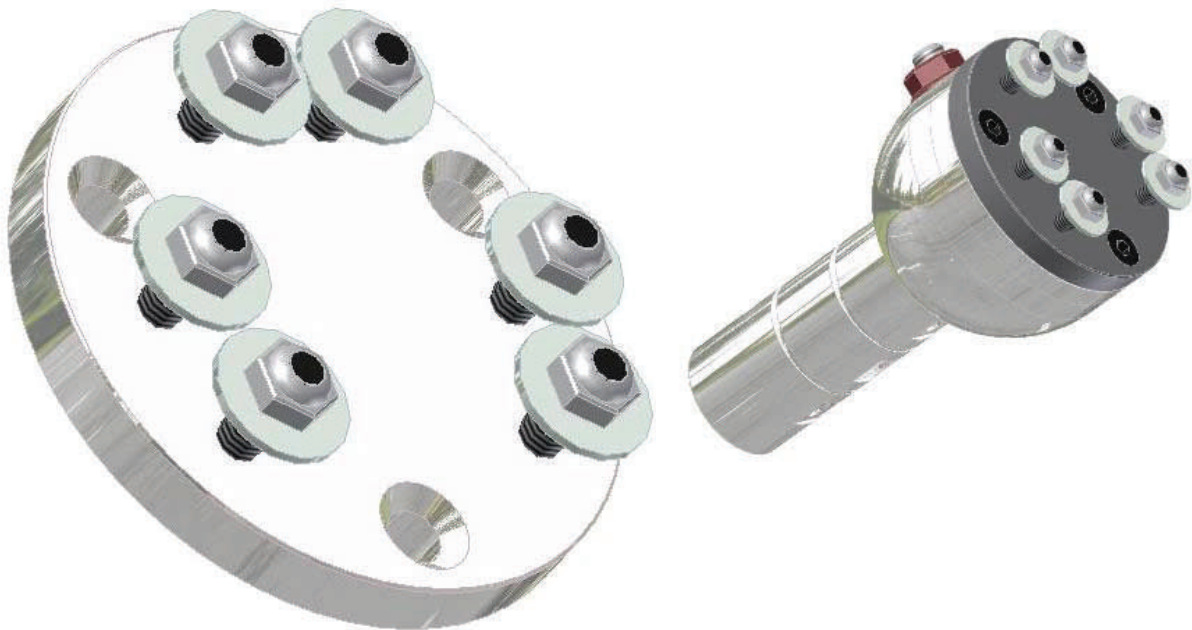

SA-016 allows you to use the steering wheel on the TONY-KART other Karts with standard 6XM5.

Price 17 € (Not included TAX and transport cost)

Stone

Lojzeta Hrovata 5
SI-4000 Kranj
Slovenija
Mr.Nenad Stojsic

Phone: +38631537758
Fax:
E-mail: stone@t-2.net

Stone

NEW PRODUCT INFORMATION

KZ CLUTCH CRANK Pn. SA-018



Handle KZ Karts for drivers to be easily mounted on the SA-015-BASIC steering wheel holder. Clutch lever is free to adjust in all directions, forward, backward, up or down. Can be used on all models, steering wheels . Clutch handel adjustment will always be parallel to the steering wheel.

Price **35 €** (Not included TAX and transport cost)

Stone

Lojzeta Hrovata 5
SI-4000 Kranj
Slovenija
Mr.Nenad Stojsic

Phone: +38631537758
Fax:
E-mail: stone@t-2.net